

18.-22.11.2024 | GAB Portugal Spanien  
Stefan Becher



„Elektrische Zugausrüstung für Bestands- und Neufahrzeuge“

A blurred photograph of a high-speed train, likely a TGV, moving rapidly. The train is red and white, and the background is out of focus, suggesting speed.

**Gesellschaft für  
Elektrische Zugausrüstung  
Rail Solutions**

# GEZ RS - Project and Turnkey Partner

## Railway equipping passionate since 1905

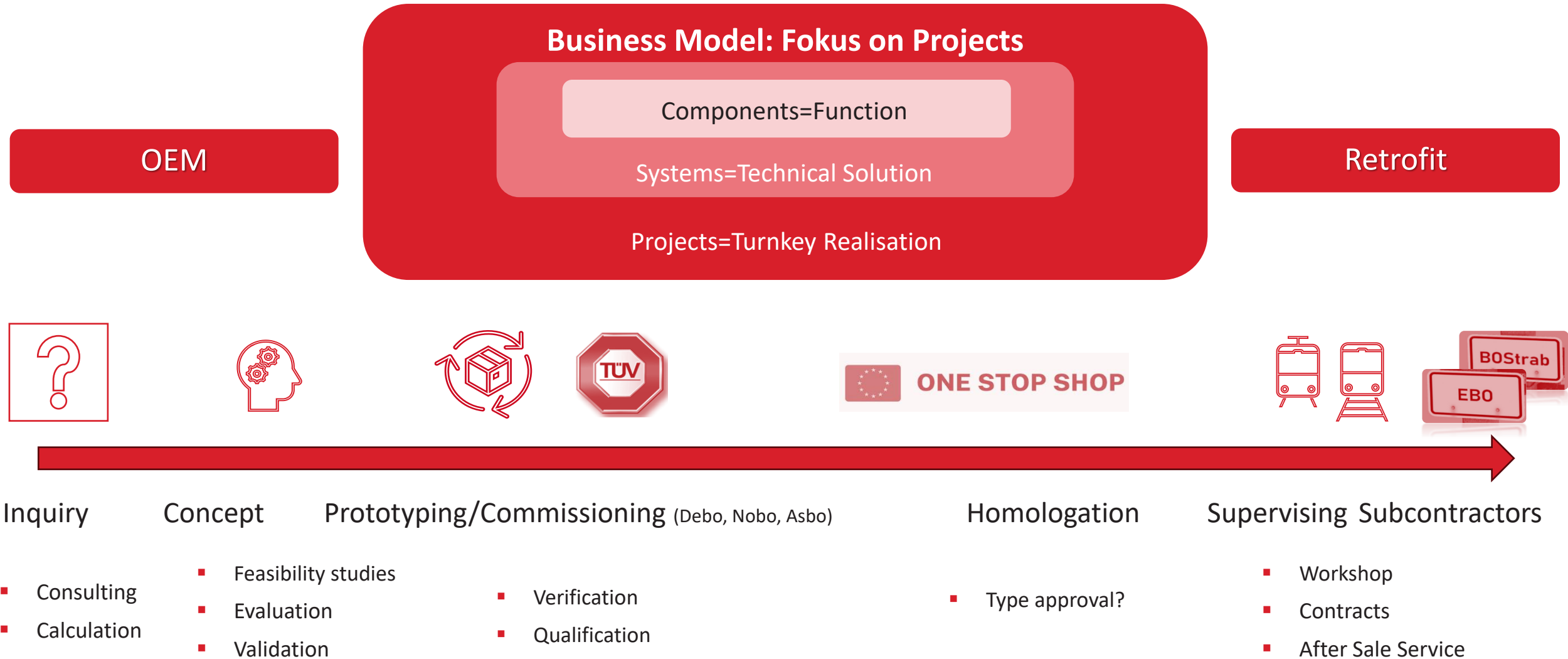

# Doorsystems and Components

## Cabin

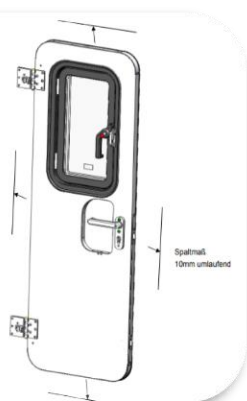

## Vestibule-Fire protection

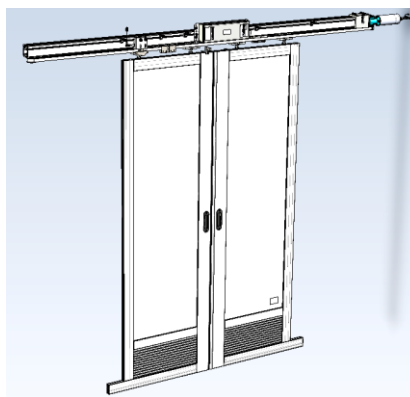
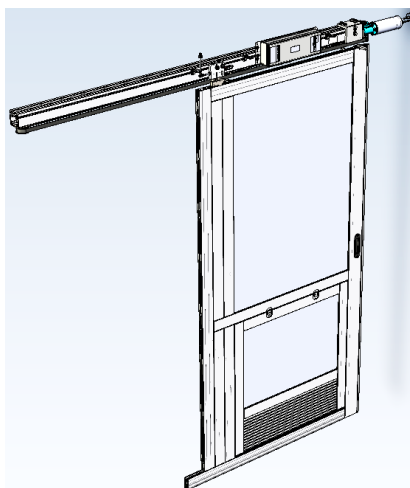

## Retrofit Passenger Metro, LRV, Tram

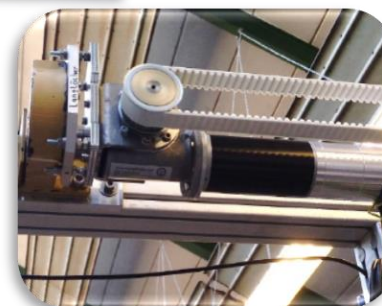
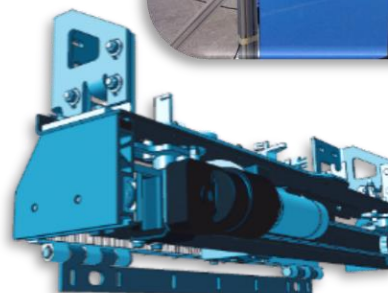

## Control Units





# Boarding Aid Systems and Components



## OEM and Refurbishment

- Safety relevant
- Barrier free
- Various type of platform level
- Customized and modular plug and play solutions
- Electronic or pneumatic

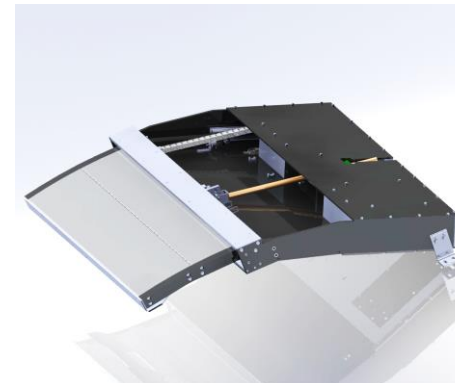

# Exterior lights

## Standard fit and tailor made

5 in 1

TSI Loc Pas EN15153-1 in each position

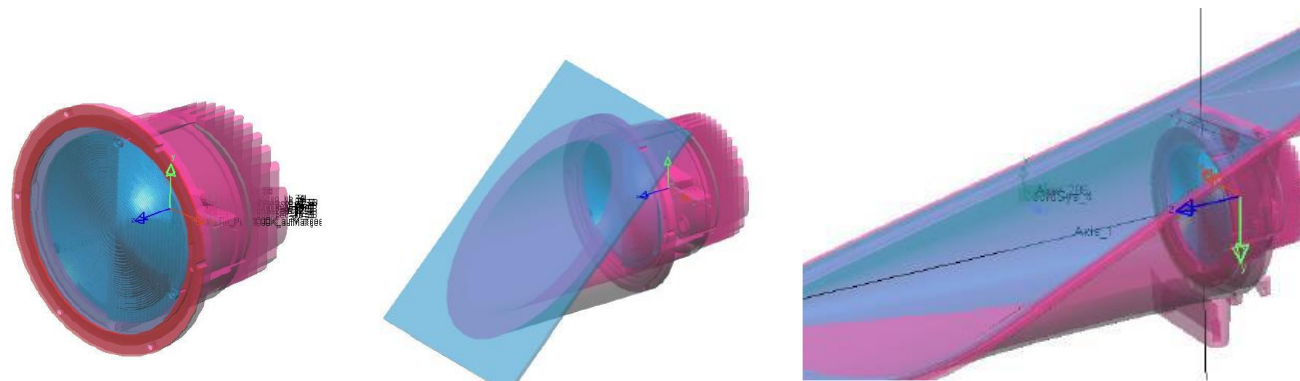

Custom Design

LRV to Highspeed  
TSI compliant

Real Cut-off

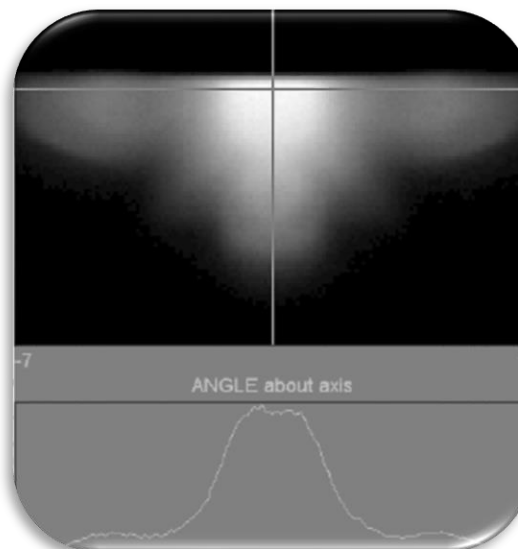



# EVA AUX and BC

Passenger Coaches



OEM and Refurbishment

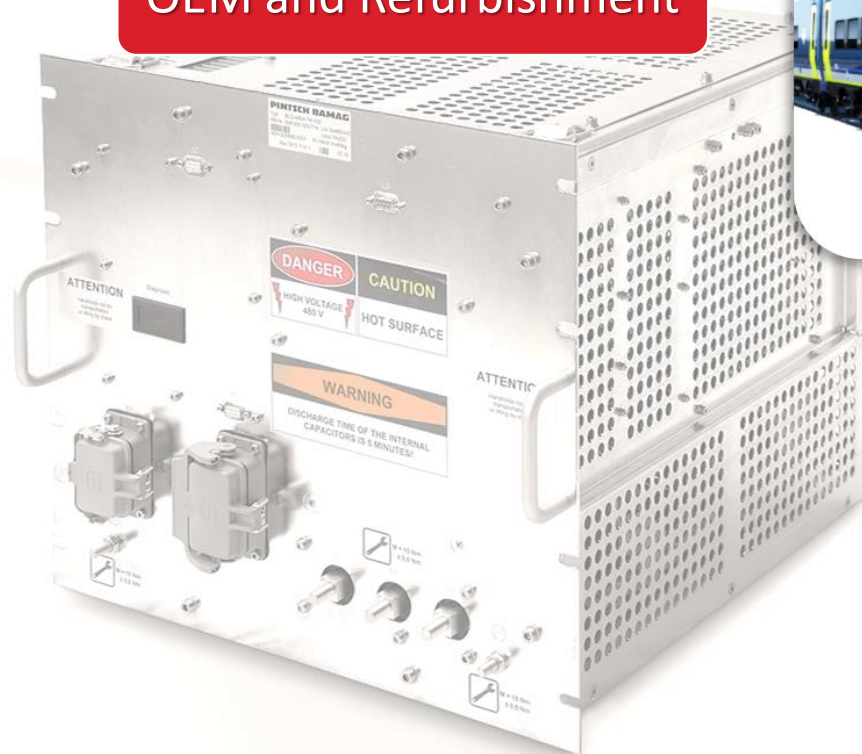

Locomotive



# References in Refurbishment

## Upcycling

Full Modernisation of Subway  
for 2nd life operation

750 VDC → 1500 VDC

- # Traction
- # own ATP design based on PZB
- # Brake
- # own TCMS
- # AUX, doors, lights
- # drivers desk

## ETCS Refit

- # Reverse Engineering
- # Documentation
- # Commissioning
- # Homologation
- # Training
- # After Sales-Service



## Conceptual Design

- # Diesel vs. Electric Drive mode
- # Cost efficiency study Diesel → Electric
- # Redesign and OEM







**RAIL SOLUTIONS**

**Thank you for your attention.**

GEZ Rail Solutions GmbH

Hünxer Straße 149 | 46537 Dinslaken

[www.gez-rs.com](http://www.gez-rs.com)